

GROUND FLOOR
365 sq.ft. (33.9 sq.m.) approx.

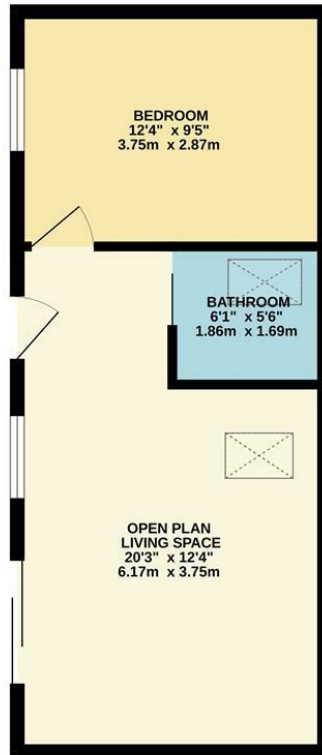

TOTAL FLOOR AREA : 365 sq.ft. (33.9 sq.m.) approx.
Whilst every attempt has been made to ensure the accuracy of the floorplan contained here, measurements of doors, windows, rooms and any other items are approximate and no responsibility is taken for any error, omission or mis-statement. This plan is for illustrative purposes only and should be used as such by any prospective purchaser. The services, systems and appliances shown have not been tested and no guarantee as to their operability or efficiency can be given.
Made with Metropix 52025

40 Lee Road, Leamington Spa
£795 Per Month

charlesrose.



One bedroom property which has been freshly decorated throughout, with new carpets and freshly painted. Located just a 10 minute walk to Leamington Train Station.

The lounge/ kitchen area has sliding doors which open out onto the patio area allowing lots of light in.

The double bedroom is a good size with plush carpets and the bathroom has a shower over bath and skylight.

Small private patio.
Professionals only.

Available Now.

EPC Rating C
Council Tax Band A

Holding deposit £180
Security Deposit £915

charlesrose.

- 01926 832411
- hello@charlesrose.co.uk
- charlesrose.co.uk

